



To: Martin van der Meulen
 From: Frank Silvis
 Date: 13th January 2021
 Subject: The energetic effect of a Chestahedron – part 2



*Figure 1:
 Chestahedron
 Beechwood*

Weight	363 grams
Base	Triangel with sides of 105 mm
Height	135 mm

When Martin and I were talking about the first memo of 28 December with measurement results of the energetic effect of a Chestahedron, he told me that other researchers had also noticed that the Chestahedron reduces the electromagnetic load in houses.

This remark encouraged me to do an experiment with the Chestahedron in the house of one of our neighbours.

This time I measured the zero situation in a few places in the house. This is about the Bovis value at the spot and/or the energetic condition expressed in a Vortex / b Left / c Right Polarity, where a, b and c are numbers. Vortex and right polarity stand for positive energy and left polarity for negative energy. See also part 1 of 28 December for a more detailed explanation of these quantities.

Next I placed the Chestahedron in the meter cupboard. In the meter cupboard there is a smart electricity meter and a router/modem of Ziggo. For practical reasons, I have chosen to place the Chestahedron on the router. See figures 2 and 3.

Next, I made three measurements:

1. The energetic radiation when I stand 1 m in front of the closed meter cupboard.
2. The energetic situation on a spot in the middle of the living room.
3. The energetic situation on two energy lines of the West line, which are part of the Hartmann-net.



Figures 2 and 3: The Chestahedron placed on Ziggo's modem/router

1. The energetic radiation from the cupboard at a distance of 1 m

	Zero situation	With Chestahedron on top of the modem
Energetic radiation from the meter cupboard at a distance of 1 m from the closed meter cupboard door	-4,400 Bovis	+40,500

Table 1: effect of the Chestahedron 1 meter in front of the meter cupboard

During the zero-situation the Bovis value was below 0 (-4,400) and the third chakra was heavily burdened. After placing the Chestahedron on the modem, calmness arose in my third chakra and the Bovis value appeared to have become +40,500.

Why do I mention chakra 3? Because that is the main chakra that is burdened by electromagnetic radiation. The chakra that is next burdened by this is chakra 5.



2. The energetic situation in the middle of the living room

		Zero situation	With Chestahedron on top of the modem
1	Bovis value in the room	+ 7,800 Bovis	+20,400
2	Energetic quality	0 Vortex / 9 Left / 12 Right	2 Vortex / 0 Left / 13 Right
3	Pathological score	4.06	1.99
4	Dowsing rod position when measuring electro- smog	36 degrees	67 degrees

Table 2: Energetic situation in the living room in the middle of point A in figure 4

Ad 1: The Bovis value in the middle of the room increases from +7,800 to +20,400.

Ad 2: The negative left polarity of 9 is reduced to 0 and the Vortex value increases from 0 to 2. Whereas the total energetic quality used to be $-9+12=+3$, it has now increased to $+2+13=+15$. The optimum would be for an average house: 12 Vortex / 0 Left / 12 Right, or $12+12=+24$.

Ad 3: It is possible to measure the total pathological score in a room on a scale of 0 to 10. 0 means no pathology at all, 10 means an extreme amount of pathology.

In the baseline situation, the pathological score is 4.06 in the middle of the room, which is a very normal value for a home. After the installation of the Chestahedron, this value decreases to 1.99 in this area. A little more than half of the total pathology at this spot is neutralised by the Chestahedron.

Ad 4: When I stand in the middle of the room with my dowsing rod in my hands in the neutral position, then my rods are at 90 degrees to the front of my body.

When I tune in to the electromagnetic load on the spot, the rods turn so that the angle between my rods and the front of my body becomes 36 degrees.

If I do the same with the Chestahedron on the modem, the angle becomes 67 degrees. So that is a much lower electromagnetic load at point A.

3. The energetic situation on two energy lines of the West line

The West Line of the Hartmann network has a relationship with electromagnetic load in the home. So it is interesting to see if the quality of the Westlines changes by placing the Chestahedron on top of the modem.

Figure 4 shows the floor plan of the house. MK = meter cupboard.

Point A is of the measurement in the middle of the room. Point B is on the northernmost west line through the house, and point C on the third west line through the house.



Ad 1: The west line through C is closer to the meter cupboard than that through B, and point C therefore shows a higher increase in the Bovis value.

Ad 2: And also a higher energy quality improvement:

At point B from 0 V/10 L/ 8R = -10+8=-2 to 2 V/0 L/11 R = +2+11=+13. Increase 15.

At point C from 0 V/11 L/ 8R = -11+8=-3 to 3 V/0 L/13 R = +3+13=+16. Increase 19.

		Zero situation	With Chestahedron on the modem
1	Bovis value west B Bovis value west C	+ 7,250 + 7,400	+17,850 +18,900
2	Energy quality B Energy quality C	0 Vortex / 10 Left / 8 Right 0 Vortex / 11 Left / 8 Right	2 Vortex / 0 Left / 11 Right 3 Vortex / 0 Left / 13 Right

Table 3: Energetic quality at points B and C on the west lines of the Hartmann grid

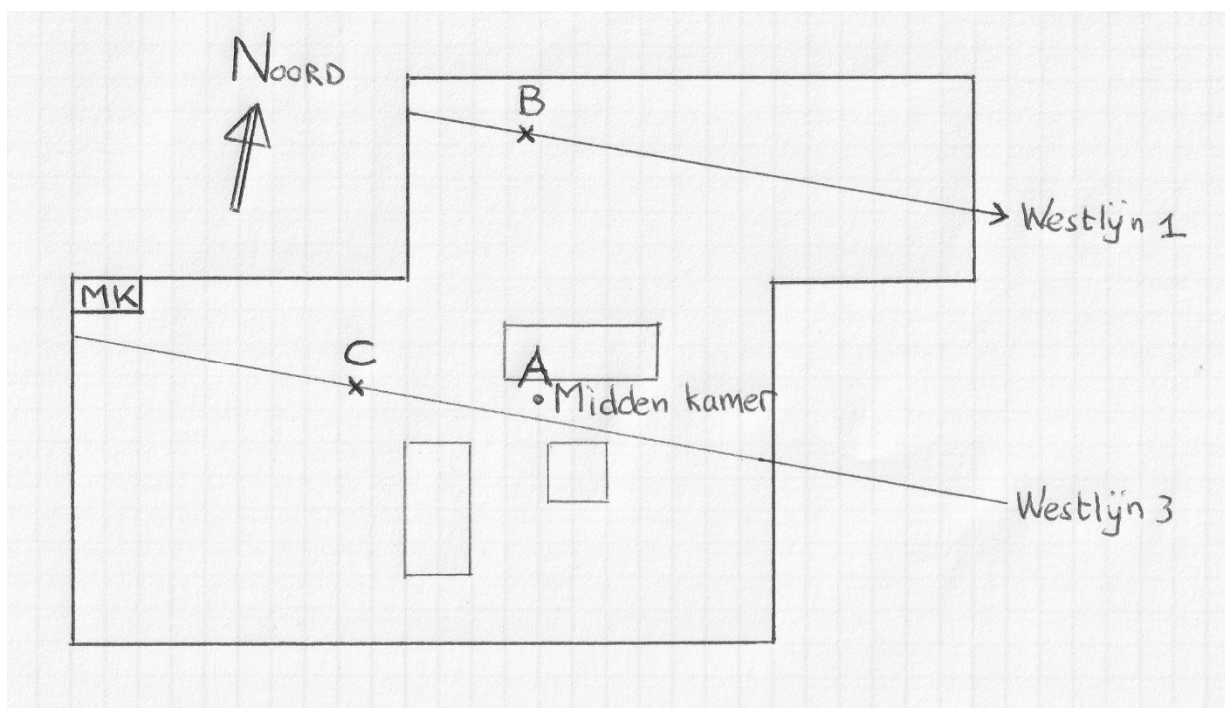

Figure 4: House plan with measuring points A (middle room) and B (west line 1) and C (west line 3) and position MK = meter cupboard

Conclusion: the Chestahedron does indeed provide a significant reduction in the electromagnetic load in a home; in addition, there is an improvement in the overall energy quality of the home.

This is expressed both in Bovis value, the measure of life energy, as well as in the Pathological Score and the energetic quality indication of the Hartmann and Curry nets.

For the latter, see also the first memorandum of December 28.